

The main case is not shown but is similar to the ZF5HP19FL

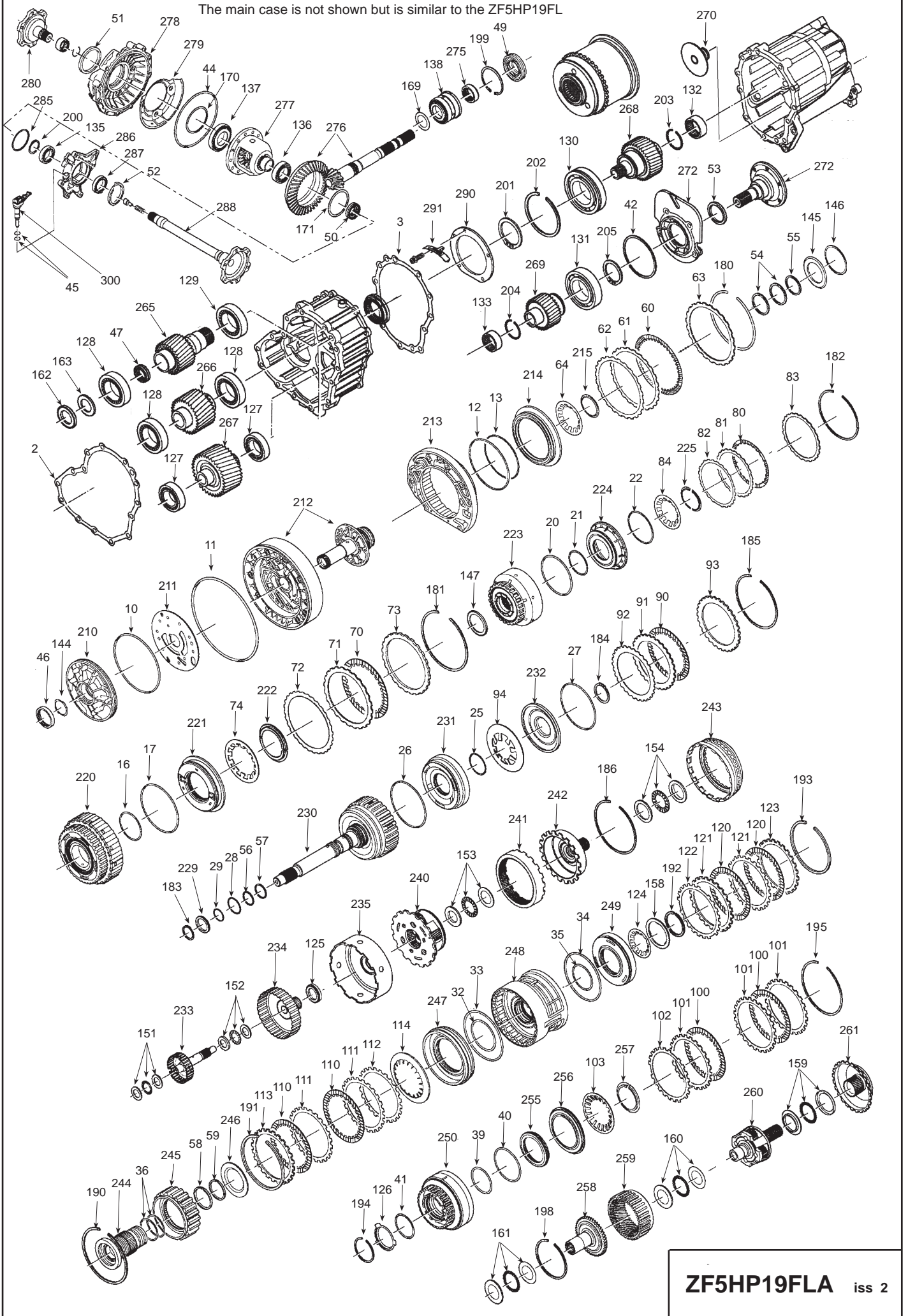

ZF5HP19FLA iss 2



Illus	Description	Part No.
	KITS	
	Overhaul	213 02 07
	GASKETS	
NI	Pan	213 25 03
2	Intermediate case to main case	213 25 04
3	Ext house to Inter case	213 25 07
NI	Valve body to plate	213 25 05
	RUBBER COMPONENTS	
10	Pump to stator support flange "O"	213 16 01
11	Stator support flange to case "O"	213 16 09
12	"C" clutch piston outer "O" ring	137 16 05
13	"C" clutch piston inner "O" ring	208 16 04
16	"B" clutch piston inner "O" ring	213 16 02
17	"B" clutch piston outer "O" ring	180 16 11
20	"A" clutch piston outer "O" ring	157 16 01
21	"A" clutch piston inner "O" ring	183 16 05
22	"A" clutch "O" ring	213 16 03
25	"E" clutch inner "O" ring	213 16 04
26	"E" clutch outer "O" ring	180 16 05
27	"E" clutch oil dam "O" ring	137 16 06
28	Input shaft "O" ring	213 16 05
29	Input shaft "O" ring	213 16 06
32	"D" clutch inner "O" ring	137 16 06
33	"D" clutch outer "O" ring	137 16 05
34	"G" clutch outer "O" ring	213 16 02
35	"G" clutch inner "O" ring	180 16 09
36	Freewheel shaft "O" ring	2 157 16 04
39	"F" clutch inner "O" ring	137 16 06
40	"F" clutch outer "O" ring	213 16 02
41	"F" cylinder "O" ring	157 16 02
42	Vibration absorber seal ring	213 16 13
44	RH drive flange cover "O" ring	213 16 08
45	Speed sender to case "O" ring	2 213 16 11
	METAL CLAD SEALS	
46	Converter 45 x 58 x 7	212 15 01
47	Output pinion 31 x 38 x 13/10	213 15 10
48	Inter housing 47 x 61/67 x 12.5	213 15 11
49	Transfer shaft 37.5 x 88 x 16	213 15 04
NI	Selector shaft 12 x 22 x 5	213 15 02
50	Diff to trans 34 x 46/47 x 12/16	213 15 05
51	Drive shaft 75 x 90 x 8	213 15 06
52	Drive shaft 60 x 80 x 7.5	213 15 07
53	Rear wheel drive	213 15 08
	SHAFT SEALING RINGS	
54	Stator support	2 213 26 01
55	Stator support	1 213 26 02
56	Intermediate shaft	1 213 26 03
57	Intermediate shaft	1 157 26 02
58	Free wheel shaft	1 157 26 05
59	Free wheel shaft	1 157 26 05
	CLUTCH PLATES	
60	"C" clutch friction 169 X 1.6 X 40T	4 212 11 01
61	"C" clutch steels	4 212 12 12
62	"C" clutch spring steel	1 213 12 02
63	"C" clutch outer steel	1 213 12 03
64	"C" clutch diaphragm spring	1 213 24 01
70	"B" clutch friction 155 X 2.0 X 30T	2 213 11 01
71	"B" clutch steel	2 213 12 04
72	"B" clutch spring steel	1 213 12 05
73	"B" clutch outer steel	1 213 12 06
74	"B" clutch diaphragm spring	1 213 24 08

Illus	Description	Part No
80	"A" clutch friction 147 X 1.6 X 30T	5 183 11 03
81	"A" clutch steel	5 213 12 07
82	"A" clutch spring steel	1 157 12 02
83	"A" clutch outer steel	1 213 12 08
84	"A" clutch diaphragm spring	1 213 24 02
90	"E" clutch friction 108 X 1.6 X 36T	5 213 11 03
91	"E" clutch steel	5 213 12 09
92	"E" clutch spring steel	1 213 12 10
93	"E" clutch outer steel	1 213 12 11
94	"E" clutch diaphragm spring	1 213 24 03
100	"F" clutch friction 135 X 1.6 X 30T	6 157 11 03
101	"F" clutch steel	5 213 12 12
102	"F" clutch spring steel	1 213 12 13
104	"F" clutch diaphragm spring 119 X 74 X 12T	1 213 24 04
110	"D" clutch friction 147 X 1.6 X 30T	6 183 11 05
111	"D" clutch steel	6 183 12 02
112	"D" clutch spring steel	1 183 12 04
113	"D" clutch outer steel	1 183 13 02
114	"D" clutch diaphragm spring	1 213 12 21
120	"G" clutch friction 135 X 1.6 X 30T	4 157 11 03
121	"G" clutch steel	4 213 12 14
122	"G" clutch spring steel	1 213 12 13
123	"G" clutch outer steel	1 213 12 16
124	"G" clutch diaphragm spring	1 213 24 06
	FILTER	
NI	Main pick up	213 27 02
NI	Valve body thimble screen	208 27 02
	BUSHES & BEARINGS	
125	Sun gear needle bush 30.8 x 50 x 5	1 213 21 01
126	"F" cyl eared bush	1 157 21 01
127	Pinion ball bearings 34.9 x 65 x 18	2 212 21 04
128	Pinion ball bearings 46 x 75 x 18	3 212 21 02
129	Pinion ball bearing 50 x 80 x 20	1 212 21 06
130	Pinion ball bearing 55 x 100 x 21	1 213 21 07
131	Pinion ball bearing 50 x 90 x 20	1 213 21 08
132	Pinion needle bearing 40 x 47 x 16	1 213 21 09
133	Pinion needle bearing 35 x 42 x 16	1 213 21 10
135	Output flange bearing 35x62x14	1 213 21 02
136	Diff bearing 41x 68x17.5	1 213 21 03
137	Diff bearing 53.9x 88.9x 19	1 213 21 04
138	Trans shaft bearing 41.2x 82.5x63.1	1 213 21 04
139	Drive shaft bearing	
	THRUST WASHERS	
144	Pump seal washer	1 212 22 01
145	Stator needle thrust 57.9x 88x 2.8	1 213 23 02
146	Stator support shim 3.60	AR 183 22 08
146	Stator support shim 3.40	AR 183 22 09
146	Stator support shim 3.20	AR 183 22 10
146	Stator support shim 3.00	AR 183 22 11
146	Stator support shim 2.80	AR 183 22 12
146	Stator support shim 2.60	AR 183 22 13
146	Stator support shim 2.40	AR 183 22 14
146	Stator support shim 2.20	AR 183 22 15
146	Stator support shim 2.00	AR 183 22 16
146	Stator support shim 1.80	AR 183 22 17
146	Stator support shim 1.60	AR 183 22 18
146	Stator support shim 1.40	AR 183 22 19
146	Stator support shim 1.20	AR 183 22 20
146	Stator support shim 1.00	AR 183 22 21
147	"A" cyl needle thrust 57.9x75.5x3.6	1 213 23 02
151	Front inter shaft needle set	1 213 23 03
152	Rear inter shaft needle set	1 213 23 04
153	Planetary needle set	1 213 23 05
154	Ring gear needle set	1 213 23 06
157	"G" cyl thrust	1 157 22 14
158	Park lock wheel needle set (rear)	1 213 23 07
160	Ring gear needle set (rear)	1 213 23 08
161	Gearset needle set (rear)	1 213 23 08



Illus	Description	Part No.	Illus	Description	Part No			
162	Needle bearing 33 x 52 x 5	1 213 23 10	171	Crown wheel inside shim 1.70	AR 213 22 06F			
163	Selective washer 8.60	AR 213 22 07A	171	Crown wheel inside shim 1.65	AR 213 22 06G			
163	Selective washer 8.40	AR 213 22 07B	171	Crown wheel inside shim 1.60	AR 213 22 06H			
163	Selective washer 8.20	AR 213 22 07C	171	Crown wheel inside shim 1.55	AR 213 22 06J			
163	Selective washer 8.00	AR 213 22 07D	171	Crown wheel inside shim 1.50	AR 213 22 06K			
163	Selective washer 7.80	AR 213 22 07E	171	Crown wheel inside shim 1.45	AR 213 22 06L			
163	Selective washer 7.60	AR 213 22 07F	171	Crown wheel inside shim 1.40	AR 213 22 06M			
163	Selective washer 7.40	AR 213 22 07G	171	Crown wheel inside shim 1.35	AR 213 22 06N			
163	Selective washer 7.20	AR 213 22 07H	171	Crown wheel inside shim 1.30	AR 213 22 06P			
163	Selective washer 7.00	AR 213 22 07J	171	Crown wheel inside shim 1.25	AR 213 22 06R			
163	Selective washer 6.80	AR 213 22 07K	171	Crown wheel inside shim 1.20	AR 213 22 06S			
163	Selective washer 6.60	AR 213 22 07L	171	Crown wheel inside shim 1.15	AR 213 22 06T			
163	Selective washer 6.40	AR 213 22 07M	171	Crown wheel inside shim 1.10	AR 213 22 06U			
163	Selective washer 6.20	AR 213 22 07N	171	Crown wheel inside shim 1.05	AR 213 22 06V			
169	Transfer shaft shim 1.87	AR 213 22 04A	171	Crown wheel inside shim 1.00	AR 213 22 06W			
169	Transfer shaft shim 1.84	AR 213 22 04B	CIRCLIPS					
169	Transfer shaft shim 1.81	AR 213 22 04C				180	"C" clutch selective 2.80	AR 213 32 01A
169	Transfer shaft shim 1.78	AR 213 22 04D				180	"C" clutch selective 2.60	AR 213 32 01B
169	Transfer shaft shim 1.75	AR 213 22 04E				180	"C" clutch selective 2.40	AR 213 32 01C
169	Transfer shaft shim 1.72	AR 213 22 04F				180	"C" clutch selective 2.20	AR 213 32 01D
169	Transfer shaft shim 1.69	AR 213 22 04G				180	"C" clutch selective 2.00	AR 213 32 01E
169	Transfer shaft shim 1.66	AR 213 22 04H				180	"C" clutch selective 1.80	AR 213 32 01F
169	Transfer shaft shim 1.63	AR 213 22 04J				180	"C" clutch selective 1.60	AR 213 32 01G
169	Transfer shaft shim 1.60	AR 213 22 04K				180	"C" clutch selective 1.40	AR 213 32 01H
169	Transfer shaft shim 1.57	AR 213 22 04L				181	"B" clutch selective 2.00	AR 213 32 02A
169	Transfer shaft shim 1.54	AR 213 22 04M	181	"B" clutch selective 1.80	AR 213 32 02B			
169	Transfer shaft shim 1.51	AR 213 22 04N	181	"B" clutch selective 1.60	AR 213 32 02C			
169	Transfer shaft shim 1.48	AR 213 22 04P	181	"B" clutch selective 1.40	AR 213 32 02D			
169	Transfer shaft shim 1.45	AR 213 22 04R	181	"B" clutch selective 1.20	AR 213 32 02E			
169	Transfer shaft shim 1.42	AR 213 22 04S	181	"B" clutch selective 1.00	AR 213 32 02F			
169	Transfer shaft shim 1.39	AR 213 22 04T	182	"A" clutch selective 2.80	AR 183 32 01			
169	Transfer shaft shim 1.36	AR 213 22 04U	182	"A" clutch selective 2.60	AR 157 32 07			
169	Transfer shaft shim 1.33	AR 213 22 04V	182	"A" clutch selective 2.40	AR 183 32 03			
169	Transfer shaft shim 1.30	AR 213 22 04W	182	"A" clutch selective 2.20	AR 183 32 04			
169	Transfer shaft shim 1.27	AR 213 22 04X	182	"A" clutch selective 2.00	AR 183 32 05			
169	Transfer shaft shim 1.24	AR 213 22 04Y	182	"A" clutch selective 1.80	AR 183 32 05			
169	Transfer shaft shim 1.21	AR 213 22 04Z	182	"A" clutch selective 1.60	AR 183 32 07			
169	Transfer shaft shim 1.18	AR 213 22 04AA	182	"A" clutch selective 1.40	AR 183 32 08			
169	Transfer shaft shim 1.15	AR 213 22 04AB	182	"A" clutch selective 1.20	AR 183 32 09			
169	Transfer shaft shim 1.12	AR 213 22 04AC	182	"A" clutch selective 1.00	AR 183 32 10			
169	Transfer shaft shim 1.09	AR 213 22 04AD	183	Input shaft retaining ring	213 32 03			
169	Transfer shaft shim 1.06	AR 213 22 04AE	184	"E" clutch oil dam retainer	213 32 04			
169	Transfer shaft shim 1.03	AR 213 22 04AF	185	"E" clutch oil retainer 2.80	157 32 18			
169	Transfer shaft shim 1.00	AR 213 22 04AG	185	"E" clutch oil retainer 2.60	157 32 19			
169	Transfer shaft shim 0.97	AR 213 22 04AH	185	"E" clutch oil retainer 2.40	157 32 20			
170	Crown wheel to cover shim 1.90	AR 213 22 05A	185	"E" clutch oil retainer 2.20	157 32 21			
170	Crown wheel to cover shim 1.85	AR 213 22 05B	185	"E" clutch oil retainer 2.00	157 32 22			
170	Crown wheel to cover shim 1.80	AR 213 22 05C	185	"E" clutch oil retainer 1.80	157 32 23			
170	Crown wheel to cover shim 1.75	AR 213 22 05D	185	"E" clutch oil retainer 1.60	157 32 24			
170	Crown wheel to cover shim 1.70	AR 213 22 05E	185	"E" clutch oil retainer 1.50	213 32 05			
170	Crown wheel to cover shim 1.65	AR 213 22 05F	185	"E" clutch oil retainer 1.40	157 32 25			
170	Crown wheel to cover shim 1.60	AR 213 22 05G	185	"E" clutch oil retainer 1.20	157 32 26			
170	Crown wheel to cover shim 1.55	AR 213 22 05H	185	"E" clutch oil retainer 1.00	157 32 27			
170	Crown wheel to cover shim 1.50	AR 213 22 05J	186	Shaft to ring gear retainer	183 32 24			
170	Crown wheel to cover shim 1.45	AR 213 22 05K	190	Freewheel shaft	213 32 11			
170	Crown wheel to cover shim 1.40	AR 213 22 05L	191	"D" clutch plate retainer sel 4.20	AR 213 32 06A			
170	Crown wheel to cover shim 1.35	AR 213 22 05M	191	"D" clutch plate retainer sel 4.00	AR 157 32 04			
170	Crown wheel to cover shim 1.30	AR 213 22 05N	191	"D" clutch plate retainer sel 3.80	AR 213 32 06B			
170	Crown wheel to cover shim 1.25	AR 213 22 05P	191	"D" clutch plate retainer sel 3.60	AR 213 32 06C			
170	Crown wheel to cover shim 1.20	AR 213 22 05R	191	"D" clutch plate retainer sel 3.40	AR 213 32 06D			
170	Crown wheel to cover shim 1.15	AR 213 22 05S	191	"D" clutch plate retainer sel 3.20	AR 213 32 06E			
170	Crown wheel to cover shim 1.10	AR 213 22 05T	191	"D" clutch plate retainer sel 3.00	157 32 06			
170	Crown wheel to cover shim 1.05	AR 213 22 05U	191	"D" clutch plate retainer sel 2.80	AR 183 32 01			
170	Crown wheel to cover shim 1.00	AR 213 22 05V	191	"D" clutch plate retainer sel 2.60	AR 157 32 07			
171	Crown wheel inside shim 1.95	AR 213 22 06A	191	"D" clutch plate retainer sel 2.40	AR 183 32 03			
171	Crown wheel inside shim 1.90	AR 213 22 06B	191	"D" clutch plate retainer sel 2.20	AR 183 32 04			
171	Crown wheel inside shim 1.85	AR 213 22 06C	192	Circlip	157 32 12			
171	Crown wheel inside shim 1.80	AR 213 22 06D						
171	Crown wheel inside shim 1.75	AR 213 22 06E						



Illus	Description	Part No.
193	"G" clutch plate retainer sel 3.40	157 32 09
193	"G" clutch plate retainer sel 3.20	157 32 10
193	"G" clutch plate retainer sel 3.00	157 32 11
193	"G" clutch plate retainer sel 2.80	180 32 03
193	"G" clutch plate retainer sel 2.60	180 32 05
193	"G" clutch plate retainer sel 2.40	180 32 07
193	"G" clutch plate retainer sel 2.20	180 32 09
193	"G" clutch plate retainer sel 2.00	180 32 11
193	"G" clutch plate retainer sel 1.80	180 32 13
194	"F" cyl bush retainer	180 32 17
195	"F" clutch plate retainer sel 2.80	180 32 03
195	"F" clutch plate retainer sel 2.60	180 32 05
195	"F" clutch plate retainer sel 2.40	180 32 07
195	"F" clutch plate retainer sel 2.20	180 32 09
195	"F" clutch plate retainer sel 2.00	180 32 11
195	"F" clutch plate retainer sel 1.80	180 32 13
195	"F" clutch plate retainer sel 1.60	180 32 15
195	"F" clutch plate retainer sel 1.40	180 32 17
195	"F" clutch plate retainer sel 1.20	180 32 19
198	Ring gear to shaft retainer	157 32 13
199	Transfer shaft	213 32 09
200	LH drive shaft	213 32 10
201	Pinion retainer	213 32 12
202	Bearing retainer	213 32 13
203	Circlip	213 32 14
204	Circlip	208 32 25
205	Bearing retainer	213 32 15
HARD PARTS		
210	Pump	213 38 04
211	Pump wear plate	213 38 05
212	Stator support assembly	213 39 02
213	"C" clutch cyl	213 29 02
214	"C" clutch piston	213 45 01
215	"C" clutch stop ring	213 29 03
220	"B" clutch cyl	213 29 04
221	"B" clutch piston	213 45 07
222	"B" clutch stop ring	213 29 03
223	"A" clutch cyl	213 29 05
224	"A" clutch piston	213 45 03
225	"A" clutch stop ring	213 29 06
229	Collar - input shaft	213 29 07
230	Input shaft	213 64 01
231	"E" clutch piston	213 45 08
232	"E" clutch oil dam	213 29 08
233	Intermediate shaft	213 29 09
234	Sun gear shaft	157 65 01
235	Sun gear & shell	213 65 03
240	Planet carrier	213 66 03
241	Ring gear	157 29 14
242	Ring gear shaft	213 29 11
243	Spider clutch bell	213 29 27
244	Free wheel shaft	213 44 01
245	Free wheel	213 44 02
246	Free wheel washer	157 22 08
247	"D" clutch piston	157 45 09
248	"D" & "G" clutch cyl complete assly	213 29 43
249	"G" clutch piston	213 45 05
250	"F" clutch cyl	213 29 19
255	"F" clutch piston	213 45 06
256	"F" clutch pressure plate	213 29 20
257	"F" clutch stop ring	213 29 21
258	Ring gear carrier shaft	157 29 23
259	Ring gear	157 29 24
260	Planet carrier	213 66 04
261	Sun gear & flange	213 65 02
265	Drive pinion assembly	213 29 44

Illus	Description	Part No
266	Driven pinion assembly	213 29 30
267	Idler pinion assembly	213 29 31
268	Rear drive pinion assembly	213 29 45
269	Rear driven pinion assembly	213 29 46
270	Nut	213 29 47
271	Vibration absorber	213 29 48
272	Output flange	213 29 49
275	Transfer shaft nut	213 29 35
276	Crown wheel, pinion & shaft	213 68 01
277	Differential	213 68 02
278	Differential cover	213 29 36
279	Oil baffle plate	213 29 37
280	Output flange	213 29 38
285	Sealing ring	213 29 39
286	Drive shaft support	213 29 40
287	Speed sender magnetic ring	213 29 41
288	Drive shaft	213 29 42
290	Washer	1 213 29 56
291	Baffle plate	1 213 29 57
ELECTRICAL		
NI	Inhibitor switch	213 35 06
300	Speed sender	213 35 07
NI	Valve body wire harness	213 35 08
NI	Pressure regulator	1 213 35 09
NI	Pressure regulator	3 213 35 10
NI	Solenoid valve	3 213 35 11
CONVERTERS		
	Audi codes 009, 012, 013, 016	213 30 04
	Audi codes 002, 008	213 30 05
	Audi codes 003	213 30 06
	Audi codes 018	213 30 07
	Audi codes 004, 017	213 30 08
	Audi codes 014, 015	213 30 09
TOOLS		
	Wallchart	213 33 12